

2019 Llama Fleece Show

Superintendent:

Jill Knuckles

talltailamas@gmail.com

Phone: 970-773-1499

Shorn Fleece and Walking Fiber Entry Fee:

\$15 Entry fee per class plus \$3 ALSA fee. (Waive ALSA Fee if llama is entered in halter, performance or a youth division).

Fiber Showcase Entries: \$10 per entry. Includes classes LF7-LF11.

Don't Forget – the Flat Rate Option for all Open Halter, Performance, Fleece and Specialty Classes! \$75 per llama - enter as many classes as you like for each llama entered. Or, if you prefer, pay \$15 per class per llama including walking fleece or shorn fleece.

TIMES: Refer to the llama show time schedule.

Please review the arrival map on following page to familiarize yourself with load-in location.

SHOW RULES: See ALSA Handbook-21st Edition. Entry tags and display bags will be provided at check-in. Be prepared to supply your ALSA # and (for shorn fleece and walking fleece entries) your llama's ALSA #, along with a copy of your llama's ILR form.

MAIL-IN ENTRIES:

You may also UPS fleece entries, to arrive by June 1, 2019 to:

Estes Park Events Complex

Attn: Llama Fleece Show, 1125 Rooftop Way, Estes Park, CO 80517

Include return postage and address label if you want your entry returned after the show. See special mailing instructions for Hand Spinner's Choice class below.

RIBBONS: First through third place; Grand and Reserve for Shorn and Walking Fleece.

CLASS DESCRIPTION S: See ALSA Handbook 21st Edition for details or contact show superintendent for more details.

L-71 thru L-76- Walking Fleece: Fleece will be judged on the llama beginning Friday afternoon June 7 and continuing Saturday a.m., June 8.

Shorn Fleece: Your entry may consist of entire shorn fleece, but must include at least the barrel section minus skirting.

LF1 Shorn Fleece - Suri under 24 months

LF2 Shorn Fleece - Suri 24 months and older

LF3 Shorn Fleece – Single Coat under 24 months

LF4 Shorn Fleece – Single Coat 24 months and older

LF5 Shorn Fleece – Double Coat under 24 months

LF6 Shorn Fleece – Double Coat 24 months and older

Finished Product Classes: These classes are intended to promote the use of llama and alpaca fiber by presenting educational displays of yarns and finished products made by the exhibitor. Items must be made of at least 60% Lama (Llama, Alpaca, Paco-Vicuna or Guanaco).

Felted Finished Product:

Class # Youth: LF7Y - Youth

Class # Novice: Felted LF7N - Novice Felted

Class # Advanced: LF7A - Advanced Felted

Knitted or Crochet Finished Product:

Class # Youth: LF8Y - Youth Knit/Crochet

Class # Novice: LF8N - Novice Knit/Crochet

Class # Advanced: LF8A - Advanced Knit/Crochet

Handspun Yarn:

Class # Youth: LF9Y - Youth Handspun

Class # Novice: LF9N - Novice Handspun

Class # Advanced: LF9A - Handspun

Woven Finished Product:

Class # Youth: LF10Y - Youth Woven

Class # Novice: LF10N - Novice Woven

Class # Advanced: LF10A - Advanced Woven

Other Finished Product:

Class # Youth: LF11Y - Other

Class # Novice: LF11N - Other

Class # Advanced: LF11A - Other

Walking Fleece

L-73 Suri – Under 24 months

L-74 Suri – 24 months & Older

L-75 Single Coat – Under 24 months

L-76 Single Coat– 24 months & Older

L-77 Double Coat – Under 24 months

L-74 Double Coat– 24 months & older



Coming 36 from Lyons: After exiting the canyon, Vendors & Fleece/Fiber turn left onto 4th street and then left onto Rooftop Way (Events Complex parking lot). All others, make a left on community, then a right onto the Fairgrounds property.

Coming 34 from Loveland: Take a left on Highway 36 (the first stoplight in town). Vendors & Fleece/Fiber turn right onto 4th street, then left onto Rooftop Way (Events Complex parking lot). All others, make a right onto community, then a right onto the Fairgrounds property.

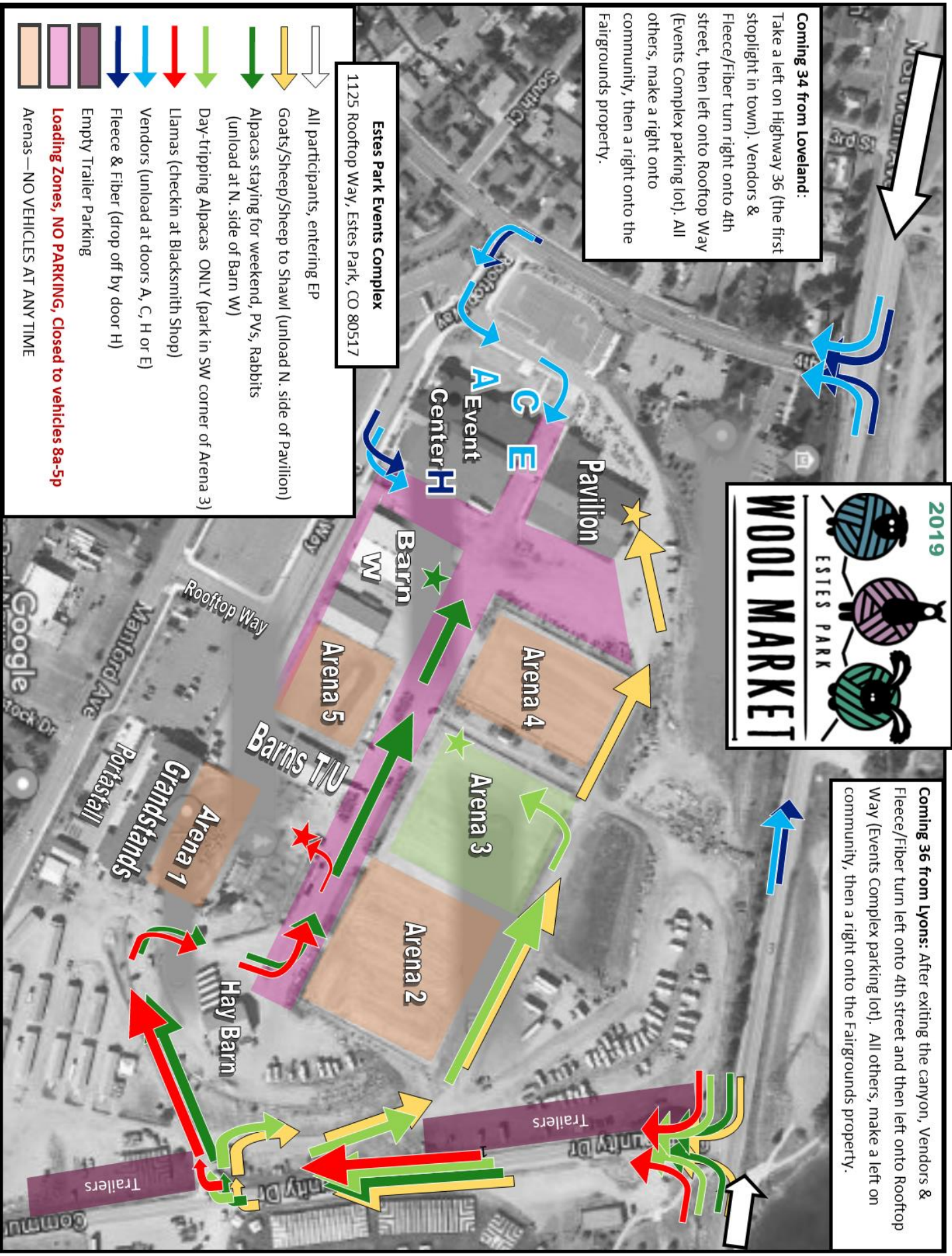

Estes Park Events Complex
1125 Rooftop Way, Estes Park, CO 80517

- ↓ All participants, entering EP
- ↓ Goats/Sheep/Sheep to Shawl (unload N. side of Pavilion)
- ↓ Alpacas staying for weekend, PVs, Rabbits (unload at N. side of Barn W)
- ↓ Day-tripping Alpacas ONLY (park in SW corner of Arena 3)
- ↓ Llamas (checkin at Blacksmith Shop)
- ↓ Vendors (unload at doors A, C, H or E)
- ↓ Fleece & Fiber (drop off by door H)
- ↓ Empty Trailer Parking
- ↓ **Loading Zones, NO PARKING, Closed to vehicles 8a-5p**
- ↓ Arenas — NO VEHICLES AT ANY TIME